

PRODUCT CARD

**WALL MOUNTED SIDE FOLDED
BASKETBALL CONSTRUCTION
PROJECTION: FROM 1,2 TO 2,45 M**

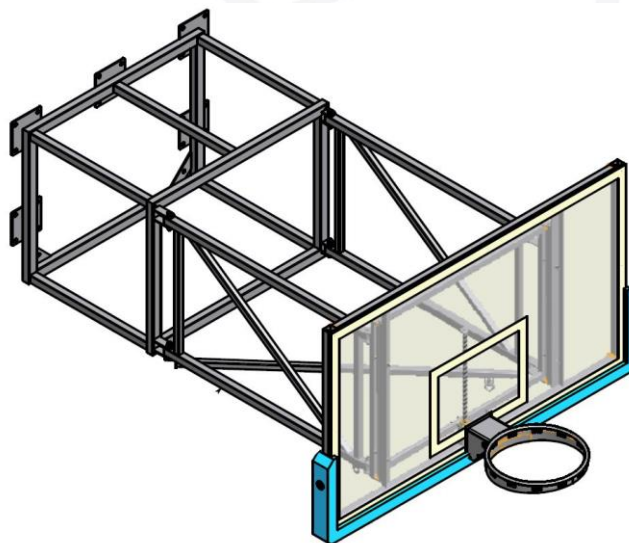
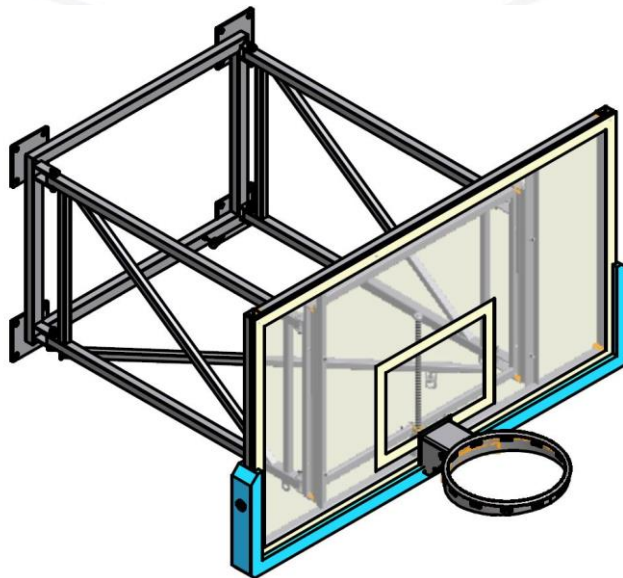

I.	List of components.....	2
II.	Complimentary products	2
III.	Product description.....	3
IV.	Product Purpose	3
V.	Installation manual	3
VI.	Instruction of use	7
VII.	Packing	7
VIII.	Warranty	7
IX.	Maintenance and Service.....	7
X.	Others	8

I. List of components:

No	Description	Symbol	Quantity
1.	Support structure		1 pce
2.	Basketball backboard		1 pce
3.	Basketball ring	3	1 pce
4.	Basketball net	8	1 pce
5.	Height regulation mechanism (+ crank) – optional		1 pce
6.	Bottom Edge safety pad (if required)		1 pce

II. Complimentary products

Name	Description
Tempered glass backboard, 180x105 cm	Professional basketball backboard, 180x105 cm, made of tempered glass 10 mm thick, stripes 5 cm wide, white. Backboard on supporting frame made of steel profiles, powder coated in white (RAL 9003). Ring mounted directly to frame for higher durability. Backboard according to EN 1270.
Acrylic backboard, 180x105 cm	Professional basketball backboard, 180x105 cm, made of acrylic glass 10 mm thickness, stripes 5 cm wide, white. Backboard on supporting frame made of steel profiles 50x40x2 mm, powder coated in RAL 5010 blue. Ring mounted directly to frame for higher durability. Backboard according to EN 1270.
Laminate backboard, 180x105 cm	Training basketball backboard, 180x105 cm, made of white epoxy board based on MDF-sheet, 22 mm thickness, stripes 5 cm wide, black. Backboard on supporting frame made of steel profiles 50x40x2 mm, powder coated in RAL 5010 blue. Ring mounted to support plate for higher durability. Backboard according to EN 1270.
Acrylic backboard, 120x90 cm	Professional basketball backboard, 120x90 cm, made of acrylic glass 10 mm thickness, stripes 5 cm wide, white. Backboard on supporting frame made of steel profiles 50x40x2 mm, powder coated in RAL 5010 blue. Ring mounted directly to frame for higher durability. Backboard according to EN 1270.
Laminate backboard, 120x90 cm	Training basketball backboard, 120x90 cm, made of white epoxy board based on MDF-sheet, 22 mm thickness, stripes 5 cm wide, black. Backboard on supporting frame made of steel profiles 50x40x2 mm, powder coated in RAL 5010 blue. Ring mounted to support plate for higher durability. Backboard according to EN 1270.
Professional bottom edge safety pad for 180x105 cm backboard.	Lower edge safety pad, 180x105, polyurethane, inner nut 55 mm, mounted by bolts. Colour blue/red/black/green.

Training bottom edge safety pad for 180x105 cm backboard.	Lower edge safety pad, 180x105, EVA-foam, inner nut 55 mm, mounted by bolts. Colour blue/red/green.
Training bottom edge safety pad for 120x90 cm backboard.	Lower edge safety pad, 120x90, EVA-foam, inner nut 55 mm, mounted by bolts. Colour blue/red/green.
Professional dunk ring	Professional dunk ring, with springs. Tubular net hatches with stainless steel pin for safety of players. Zinc-galvanized and powder coated, colour and mounting holes due to EN 1270.
Training dunk ring	Training dunk ring, with springs. Tubular net hatches with stainless steel pin for safety of players. Zinc-galvanized and powder coated, colour and mounting holes due to EN 1270.
Fixed ring	Reinforced fix basketball ring (steel plate of 5 mm thickness). For indoor use. Powder coated in orange (RAL 2008). colour and mounting holes due to EN 1270
Ring's net	Competition ring net, white, thickness 5 mm, 12 hitches, made of polypropylene.
Height adjustment mechanism	Height adjustment mechanism for basketball (260-305 cm), manual.

III. Product description

Index	
Dimensions	Projection: 1,2 m (min.), 2,45 m (max.)
Weight	
Colour	White (RAL 9003). Other upon request.
Certificate	
Description	Wall mounted basketball construction (for 1 backboard/ring). Made in accordance with EN 1270. Support structure made of steel, protected against corrosion by powder coating (in standard RAL 9003).

IV. Product Purpose

Construction is designed solely for basketball backboard with ring. .

V. Installation manual

TOOLS AND EQUIPMENT REQUIRED (not provided)

Scissor lift or scaffolding	Injectable adhesive anchors, recommended HILTI HIT-MM
Hand tools	PLUS
Laser measuring device	Steel, threaded rods (M12)
Spirit level	Angle grinder
Measuring tape	Rotary hammer with set of drills
Thick foil	Drop cord

TOOLS AND EQUIPMENT RECOMMENDED (OPTIONAL)

Fall protection for tools

RECOMMENDED SAFETY CLOTHING (to be worn during the installation and maintenance)

Hard hat	Professional harness
Steel toe work boots	Leather gloves

Step 1 – preparations	
1.1	Make sure, that you properly protected the sports flooring (in other way, the scaffolding/scissor lift, tools, falling screws/nuts or construction parts might cause serious damages of the sports surface).
1.2	Unpack the construction parts. Check if there are not any elements missing (according to provided drawing).
1.3	Prepare the scaffolding / scissor lift

Step 2 – INSTALLATION

INSTALLATION OF THE WALL SUPPORT FRAME

Drill holes according to scheme below and install the main support frame.



For units with projection bigger than 1,5 m we recommend to use Injectable adhesive anchors and M12 threaded rods with M12 self-locking nuts.

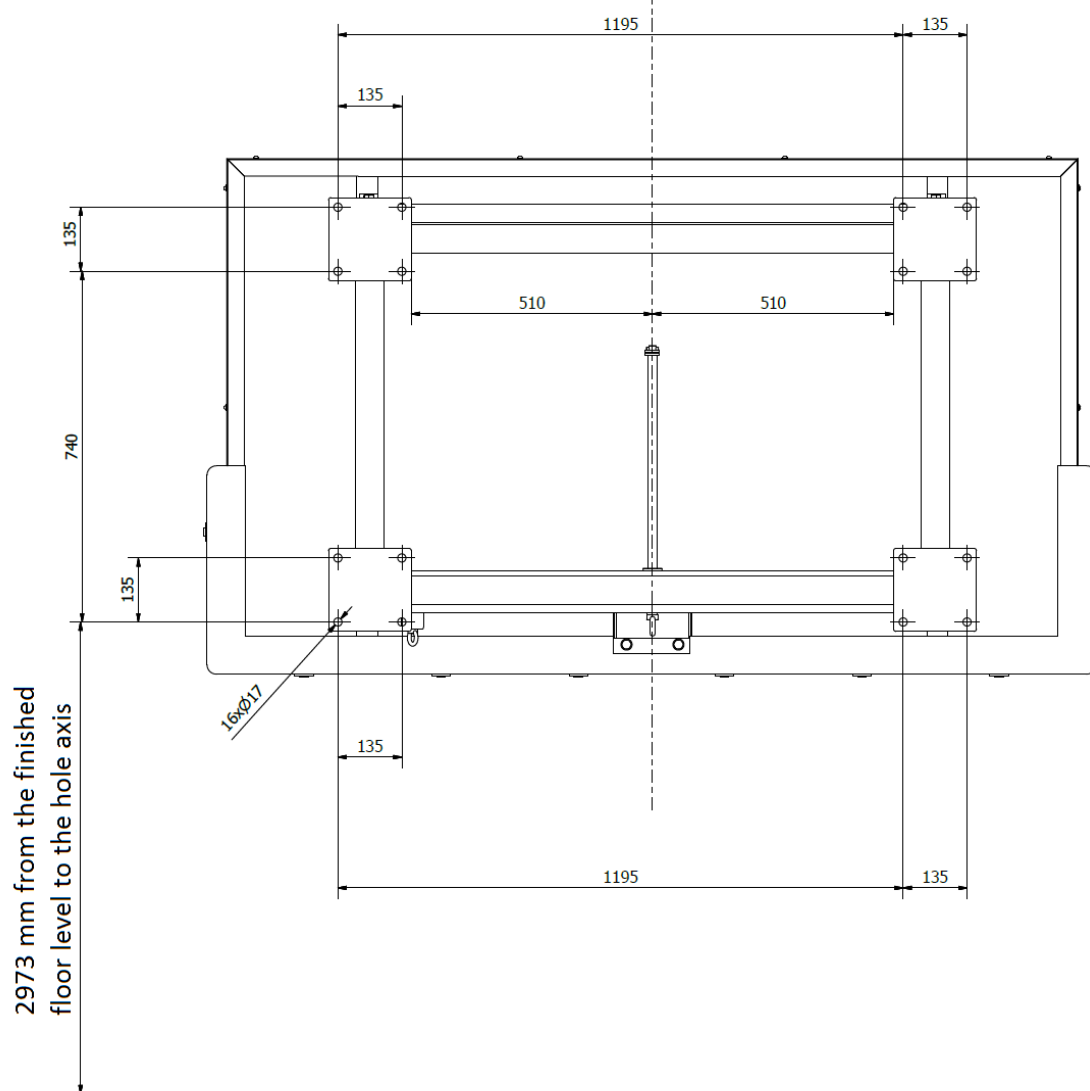

Connect the foldable frames to the wall structure.

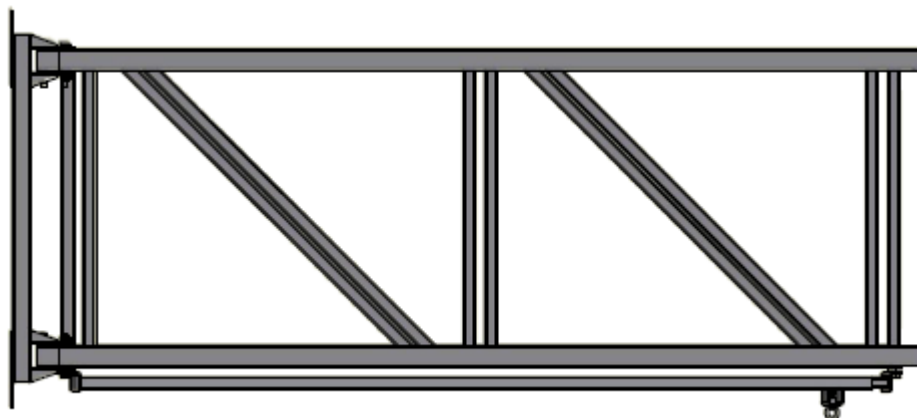

Top

Bottom

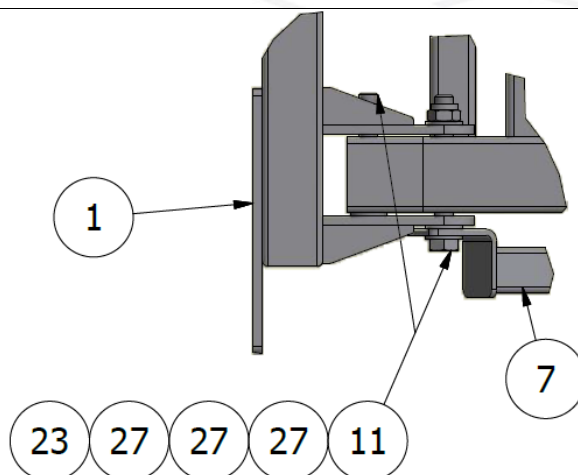
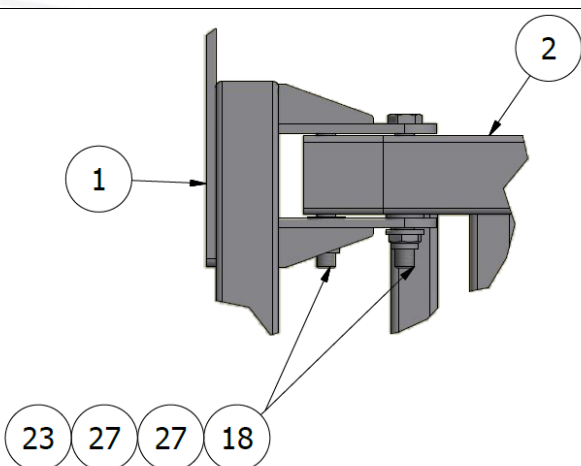

Use:

- M12x90 bolts (18)
- A13 washers (27)
- M12 self-locking nuts (23)

Use:

- M12x95 bolts (11)
- A13 washers (27)
- M12 self-locking nuts (23)

Connect the first part of the telescopic arm (7)

CONNECT THE RING TO THE BACKBOARD.

On the ground, attach the ring (39) to the backboard. Use:

- M12x50 screws (top) (20)
- M12x65 screws (bottom) (19)
- M12 washers (27)
- Nylon distance pad 160x150 mm (10)



Do not put the safety pad on yet. It can be performed later, to avoid damages.

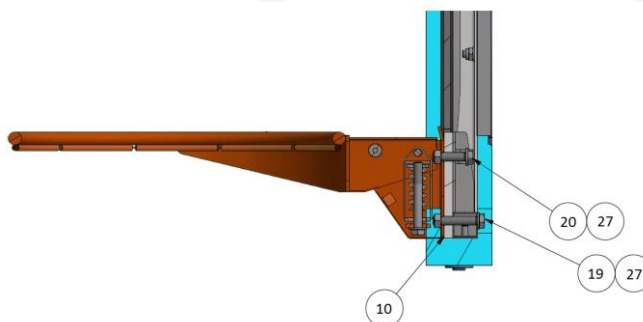

CONNECT THE BACKBOARD SUPPORT GRIPS TO PRE-INSTALLED WALL STRUCTURE.



TOP

Use:

- M12x90 bolts (18)
- A13 washers (27)
- M12 self-locking nuts (23)

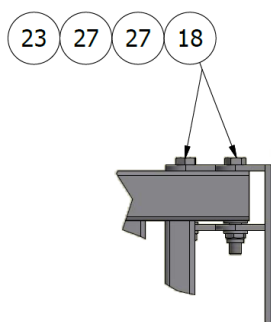

BOTTOM

Use:

- M12x90 bolts (18)
- M12x90 bolts (11)
- A13 washers (27)
- M12 self-locking nuts (23)

Connect the second part of the telescopic arm (4)

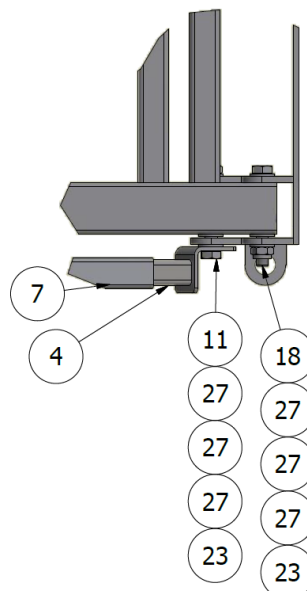

HEIGHT REGULATION MECHANISM (SKIP THIS POINT IF YOU DID NOT ORDERED IT)

To the pre-installed wall structure attach height regulation mechanism.

Use:

- M10x25 bolts
- A10,5 washers

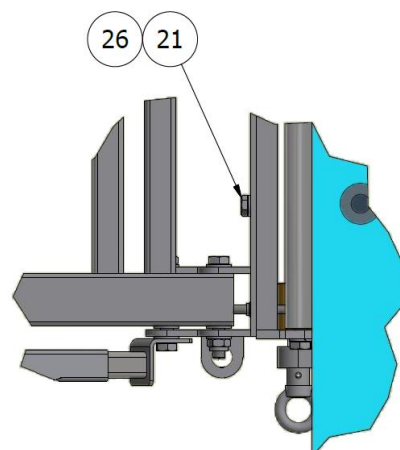
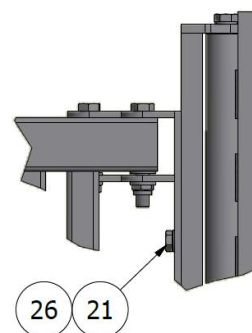

BACKBOARD

Attach the backboard to the main frame. Use:

- M10 self-locking nuts (24)
- A10,5 washers (26)

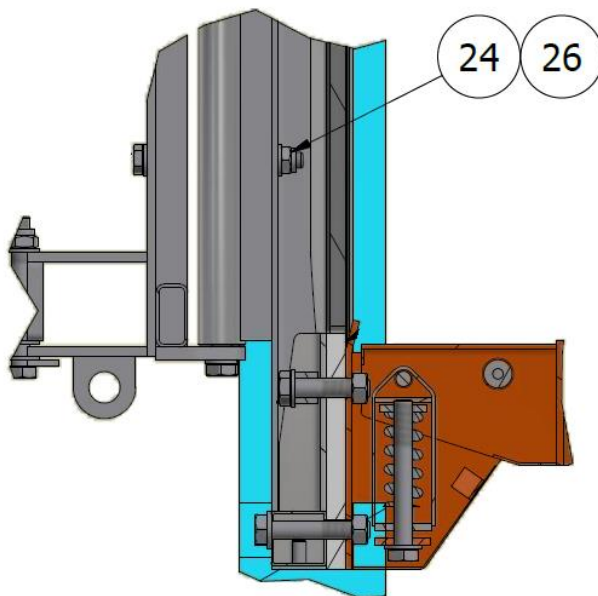

VI. Instruction of use

1. Installation and service can be performed only by the producer or dealers appointed by the producer.
2. The construction should be inspected regularly (minimum every 12 months), the inspection can be performed only by the producer or dealers appointed by the producer.
3. Construction is designed solely for playing basketball and cannot be used for any other purpose.
4. It is forbidden to climb on the construction.
5. It is forbidden to burden the equipment in any way.
6. Periodically (at least every 3 months) check the assembly nodes and tighten the screws.
7. Every visible damage should be reported to the producer or its authorized dealer. It is strictly forbidden to use the unit, when damages or atypical noises occurs.

VII. Packing

All elements are protected for transport with bubble and stretch foil.

VIII. Warranty

Detailed warranty terms are described in the attachment no 1 - **STANDARD PRODUCT WARRANTY**

IX. Maintenance and Service

For any queries regarding product, spare parts or problems please contact: help@interplastic.pl

X. Others

Table a. General bolt tightening torques in Nm (max. permissible)

Bolt diameter	Bolt Class (according to DIN 267)					
	5.6	5.8	6.8	8.8	10.9	12.9
M5	2.5	3.5	4.5	6	8	10
M6	4.5	6	7.5 5.5 ft lb	10 7.4 ft lb	14 10.3 ft lb	17
M8	11	15 11.1 ft lb	18 13.3 ft lb	24 17.7 ft lb	34 25.1 ft lb	40
M10	23	30 22.1 ft lb	36 26.6 ft lb	47 34.6 ft lb	66 48.7 ft lb	79
M12	39	52 38.4 ft lb	62 45.7 ft lb	82 60.5 ft lb	115	140
M14	62	82	98	130	180	220
M16	94	126	150	200	280	340
M18	130	174	210	280	390	470

